

The Floorplan...

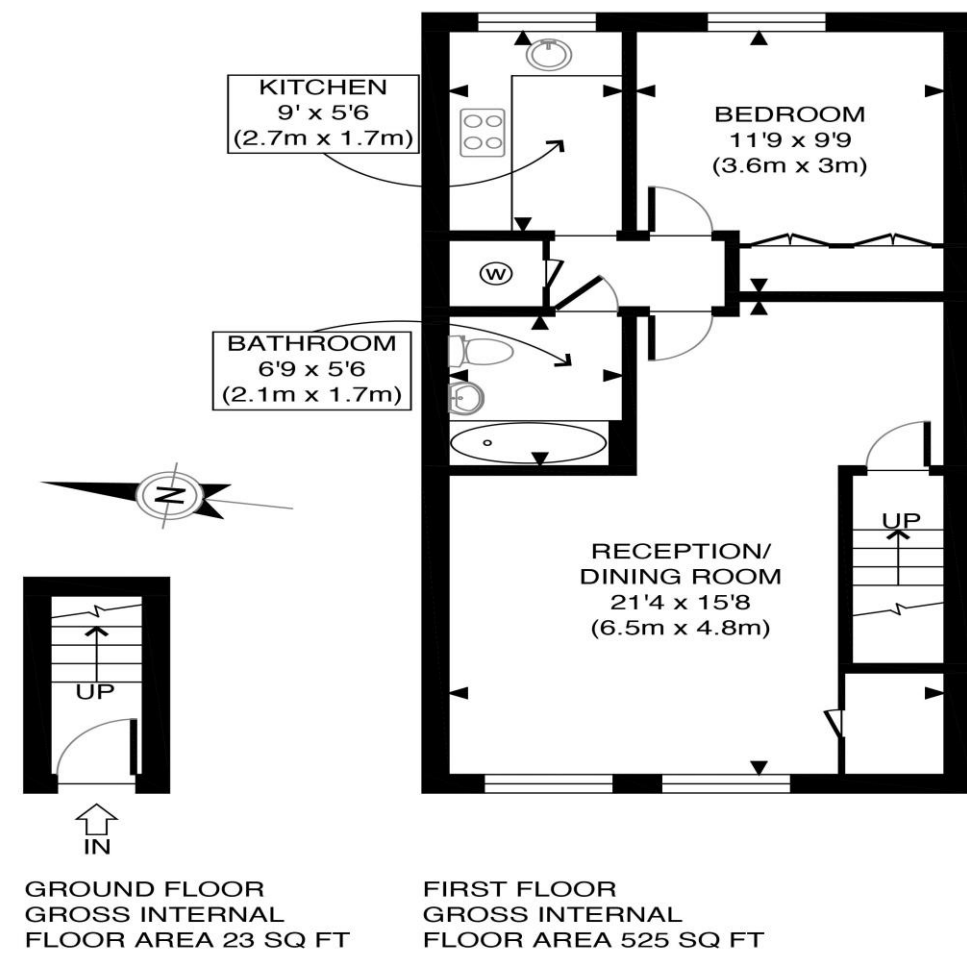

APPROX. GROSS INTERNAL FLOOR AREA 548 SQ FT / 51 SQM	Baldon Garden
Disclaimer: Floor plan measurements are approximate and are for illustrative purposes only. While we do not doubt the floor plan accuracy and completeness, you or your advisors should conduct a careful, independent investigation of the property in respect of monetary valuation	date 09/04/24
	photoplan

More Details From...

Call: Brian Cox North Harrow: 020 3866 6640
Email: Azi.rahman@brian-cox.co.uk
Web: www.brian-cox.co.uk



0203 866 6640
brian-cox.co.uk



Brian Cox Estate Agents are delighted to offer this one bedroom retirement flat to the market. The very bright and spacious flat is set in a sought after residential area of Harrow. This 1 bedroom warden assisted flat has a host of accessibility measures throughout the property, and benefits from a spacious reception room and dining area. Bladon Gardens is well located close to West Harrow and North Harrow tube station, and all the useful local amenities near Harrow town centre.



Guide Price £125,000

Bladon Gardens, Harrow HA2 7BA

Consumer Protection from Unfair Trading Regulations 2008 We have not tested any apparatus, equipment, fixtures, fittings or services and so cannot verify that they are in working order or fit for purpose. You are advised to obtain verification from your solicitor or surveyor. References to the tenure of a property are based on information supplied by the seller. We have not had sight of the title documents and a buyer is advised to obtain verification from their solicitor. Items shown in photographs are not included unless specifically mentioned within the sales particulars, but may be available by separate negotiation. We advise you to book an appointment to view before embarking on any journey to see a property, and check its availability.



In Brief...

- Cosy One Bedroom First Floor Retirement Flat
- Spacious Double Bedroom
- Shared Garden
- Walking Distance To Local Amenities & Transport Links In Harrow Town Centre
- Ample Storage Throughout
- Accessibility Features Throughout
- Bright Reception Room & Dining area
- EPC Rating TBC & Council Tax Band C



The Location...

Nearest Stations ...

West Harrow Station 0.2 miles
North Harrow Station 0.3 miles
Rayners Lane Station 0.8 miles

North Harrow is a suburban area of North West London, situated North-West of Central Harrow within the London Borough of Harrow. North Harrow train station is a London Underground station situated in North Harrow in North West London. The station is on the Metropolitan line between Harrow-on-the-Hill (southbound) and Pinner (northbound). The area is served well by local amenities including a post office, Tesco Express, a selection of restaurants, take-aways & and independent specialist shops.



brian-cox.co.uk

020 3866 6640